



...for Kindle

Libby is a digital book service available to Acorn Public Library District cardholders. To use the service you must have a valid Acorn card, in good standing, and a PIN. By default, the PIN is the last four digits of the phone number we have on file for you. If you need to reset your PIN, please contact the Library at 708.687.3700.

1. Because the Libby app is not available on Kindle devices, you will need to start the process either using another Apple or Android device where you can download the app. You can also use the website libbyapp.com.

2. To set up your card for the first time, follow the prompts on the screen. Tap 'Search For A Library.'

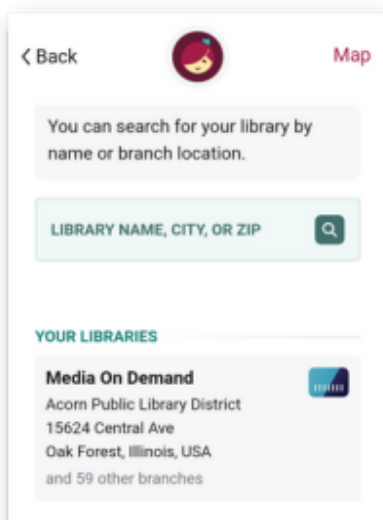
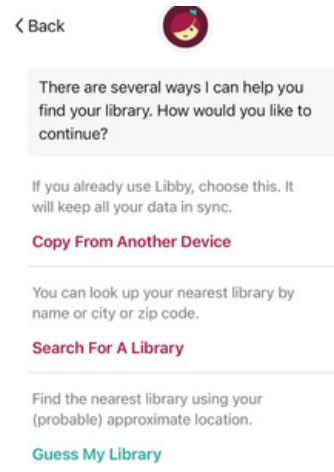

3. Search for Acorn and then tap on the Acorn Public Library District result. This will set Acorn as your home library.

Navigating Libby

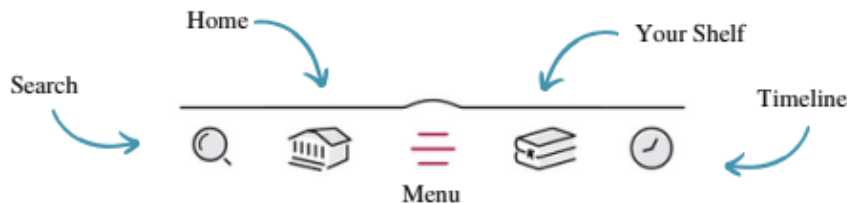

4. To check out an item, simply search for the title or author. When you find the item you want, you can either immediately borrow it by tapping 'Borrow' next to the picture of the item or 'Place Hold' if the item is currently unavailable.

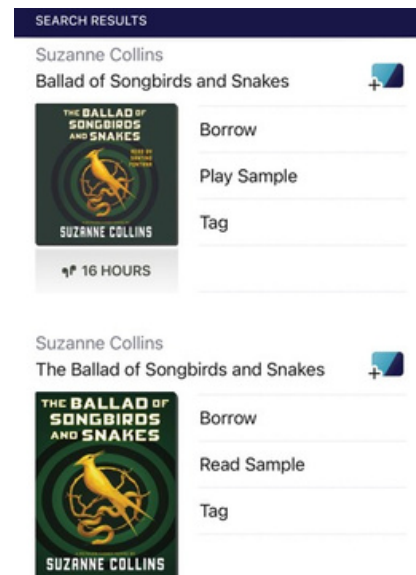

5. If the item is available, you will get a confirmation screen. Just hit the 'Borrow!' button on the bottom of the screen and you can now access that item on your current device for the indicated loan period.



Success!

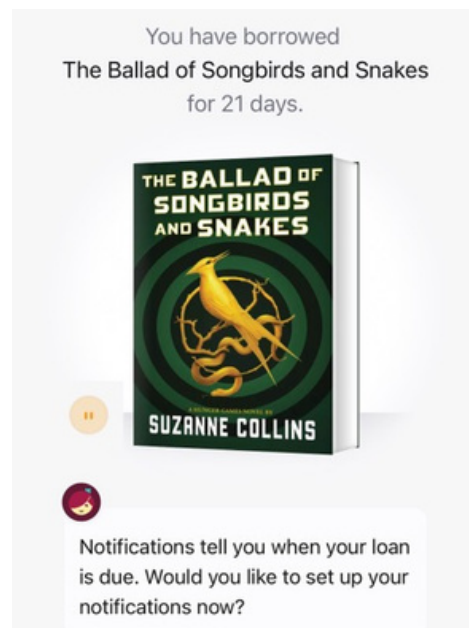

6. The item will now show up on your Shelf and in your Timeline (depending on your settings). In your Shelf area you can then send the book to your Kindle device. To send your item to your Kindle device, tap 'Read With...'

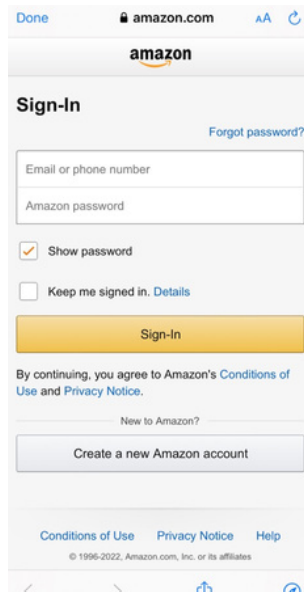
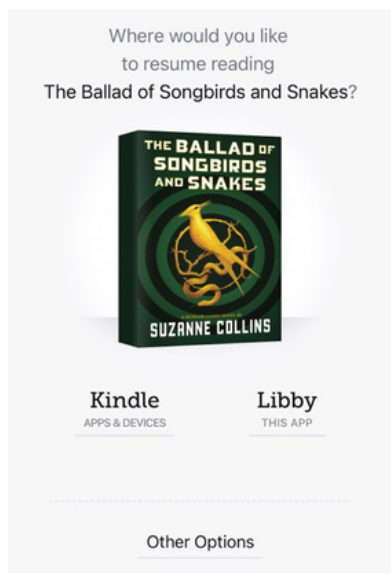
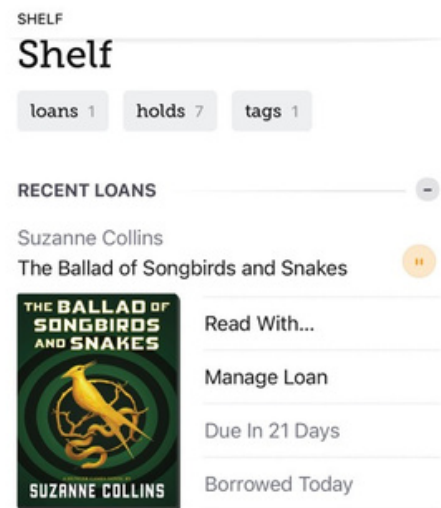

7. To read with Kindle, choose 'Kindle.' A window will open, prompting you to sign in to your Amazon account.

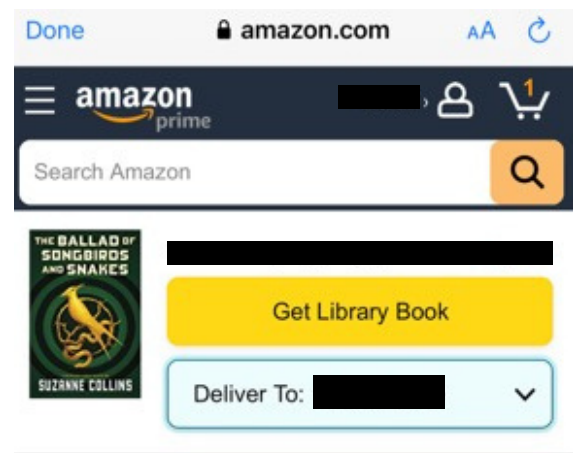

8. Once you have signed in, you will automatically be taken to a page that displays your item. In the dropdown menu, choose the device you want your item delivered to. Then click 'Get Library Book.'



9. Success! Your loan has been delivered to your Kindle device. You can now open it on your Kindle to enjoy! All returns are automatic, so you will never return an item late. Two days before an item is due, you can access Libby to either renew or place another hold on the item.